



SNOXHALL PLAY PARK PROJECT

MILESTONES OF THE PROJECT

PRESENTATION BY:
Pauline Whitehead and Nick Barnett

Snoxhall Play Park Project

Katie Webb at Waverley Borough Council submitted the application to the Big Lottery Fund for £50,000 in relation to the Play Area at Snoxhall at the beginning of September. We should know by January 2008 if the bid has been successful.

MILESTONE 1

Confirmed that the land belongs to Cranleigh Parish Council and that no planning permission is required. If the Clerk and Grounds Manager manage the project on behalf of the Council it would maximise the money spent on the equipment. If not a minimum of £4,500 would be spent on this.

MILESTONE 2

Architect's drawings will be needed to ascertain if the design fits the space. Potential cost £1,000 however, the Project Managers are working with various play equipment suppliers to produce plans free of charge.

BIG LOTTERY FUNDING £1,000 Parish Council Contribution £4,500 minimum

Snoxhall Play Park Project

MILESTONE 3

As soon as funding is secured the fence lines can be extended.

Existing fencing to be used where possible.

This could take up to 6 – 9 months

(May – July 2008)

Cost 6,000

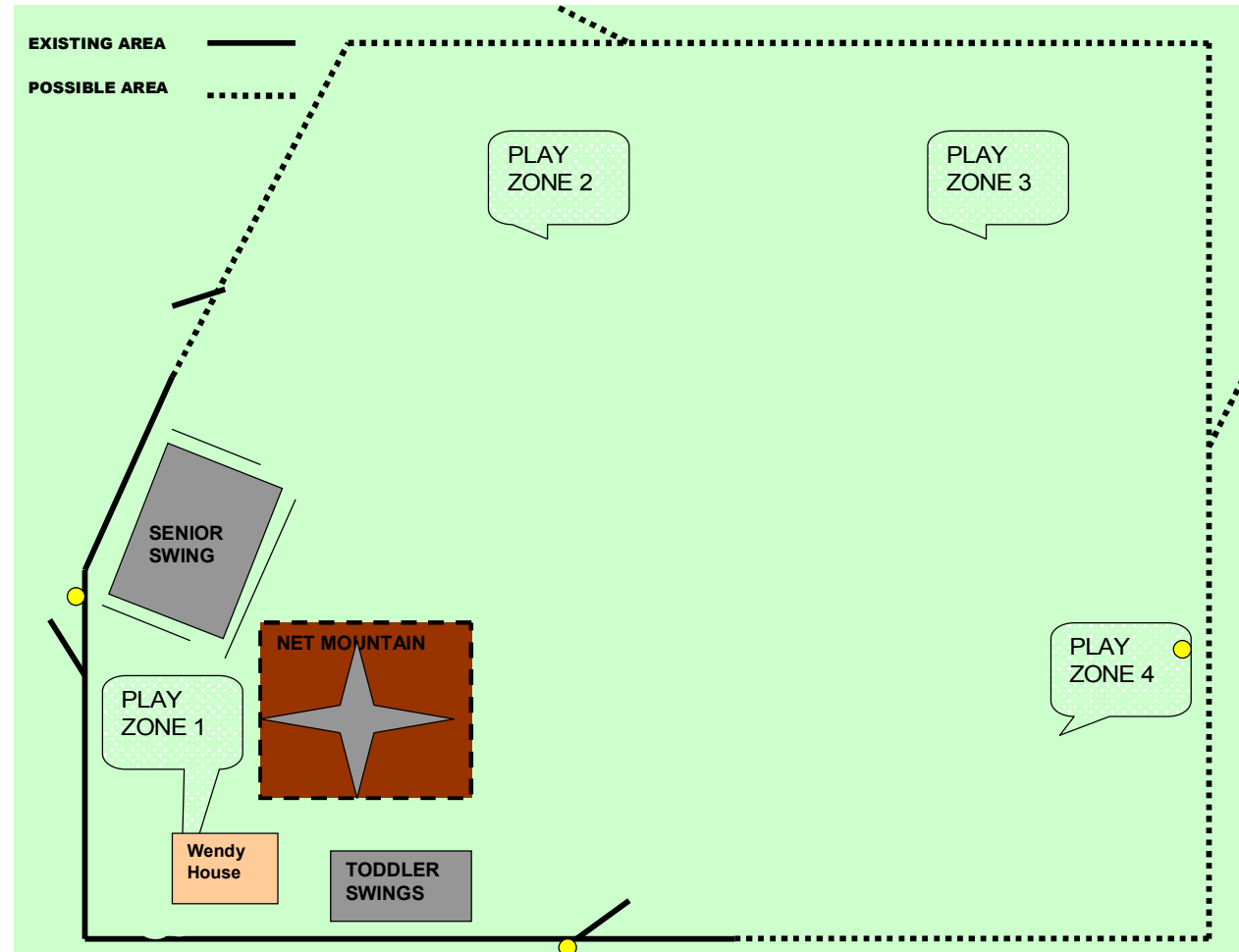

BIG LOTTERY FUNDING £7,000 Parish Council contribution £4,500 minimum

Snoxhall Play Park Project

MILESTONE 4

Creating two curving, bound gravel pathways.

This could take up to 12 months into the project.

Cost £10,000

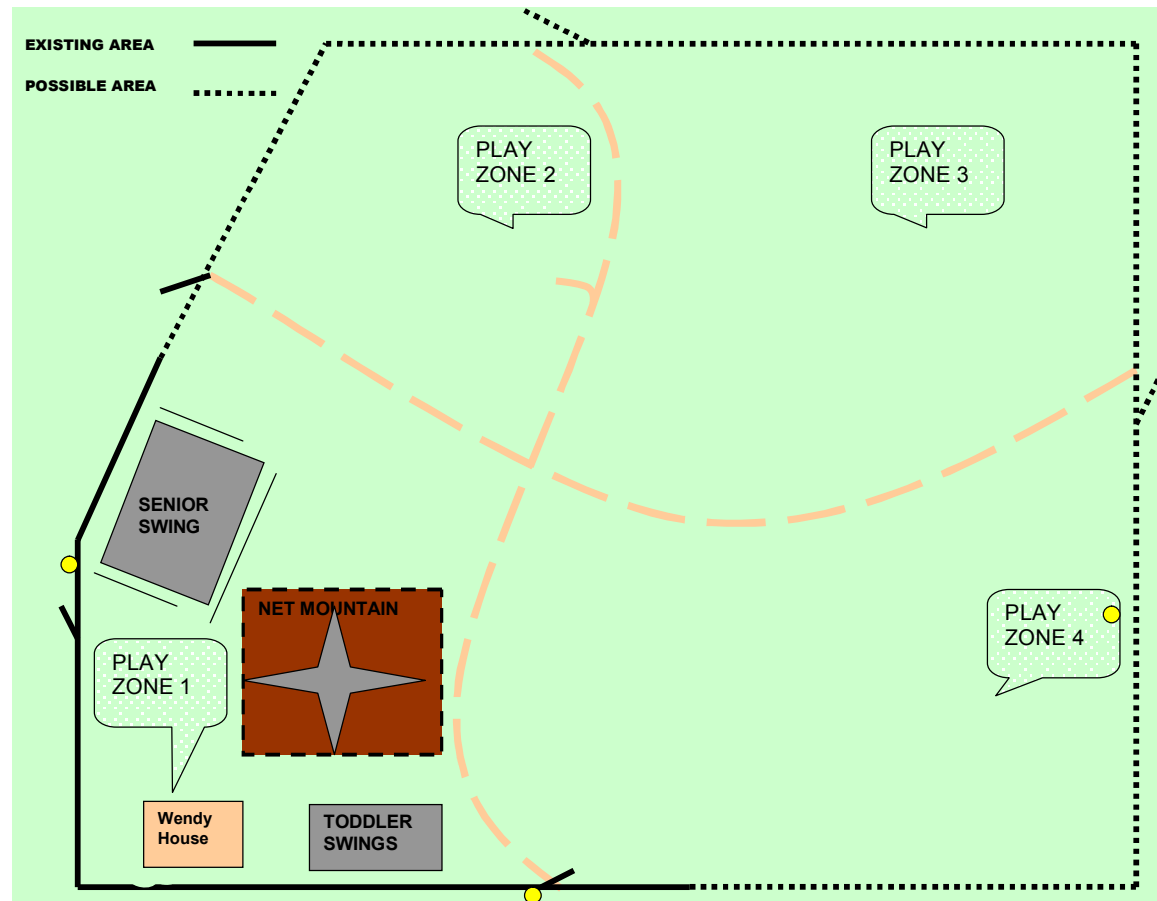

BIG LOTTERY FUNDING £17,000 Parish Council contribution £4,500 minimum.

Snoxhall Play Park Project

MILESTONE 5

Landscaping and Planting.

Continuous throughout the first twelve months of the project.

Cost £5,000

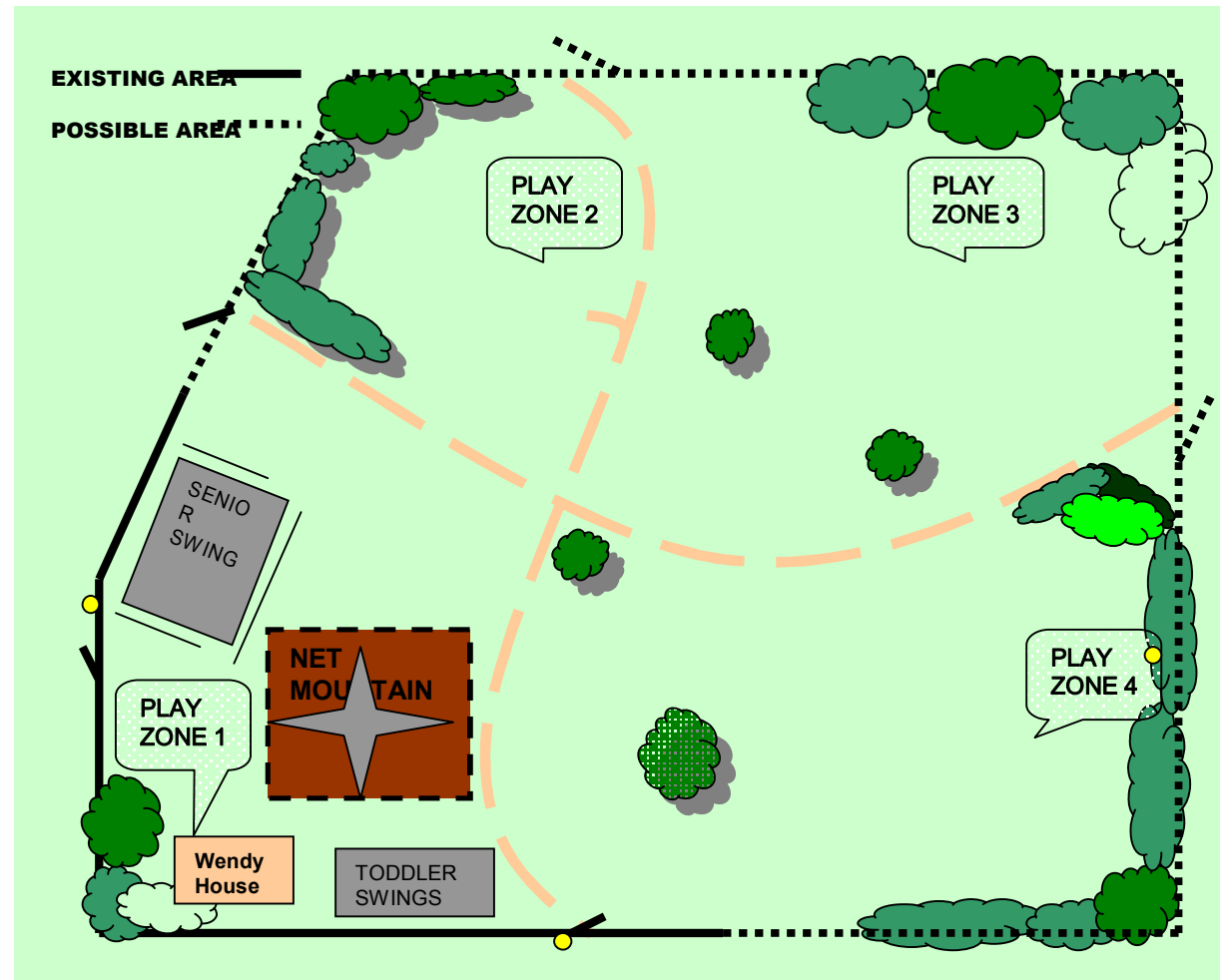

BIG LOTTERY FUNDING £22,000 Parish Council contribution £4,500 minimum

Snoxhall Play Park Project

MILESTONE 6

Communal areas by
June 2009

Cost £6,500

Additional funding.

Cross scales £6,250

Super Nova £3,600

£9,850 Awards for All.

£6,000 available from
EMR (money set aside
for replacement
multiplay)

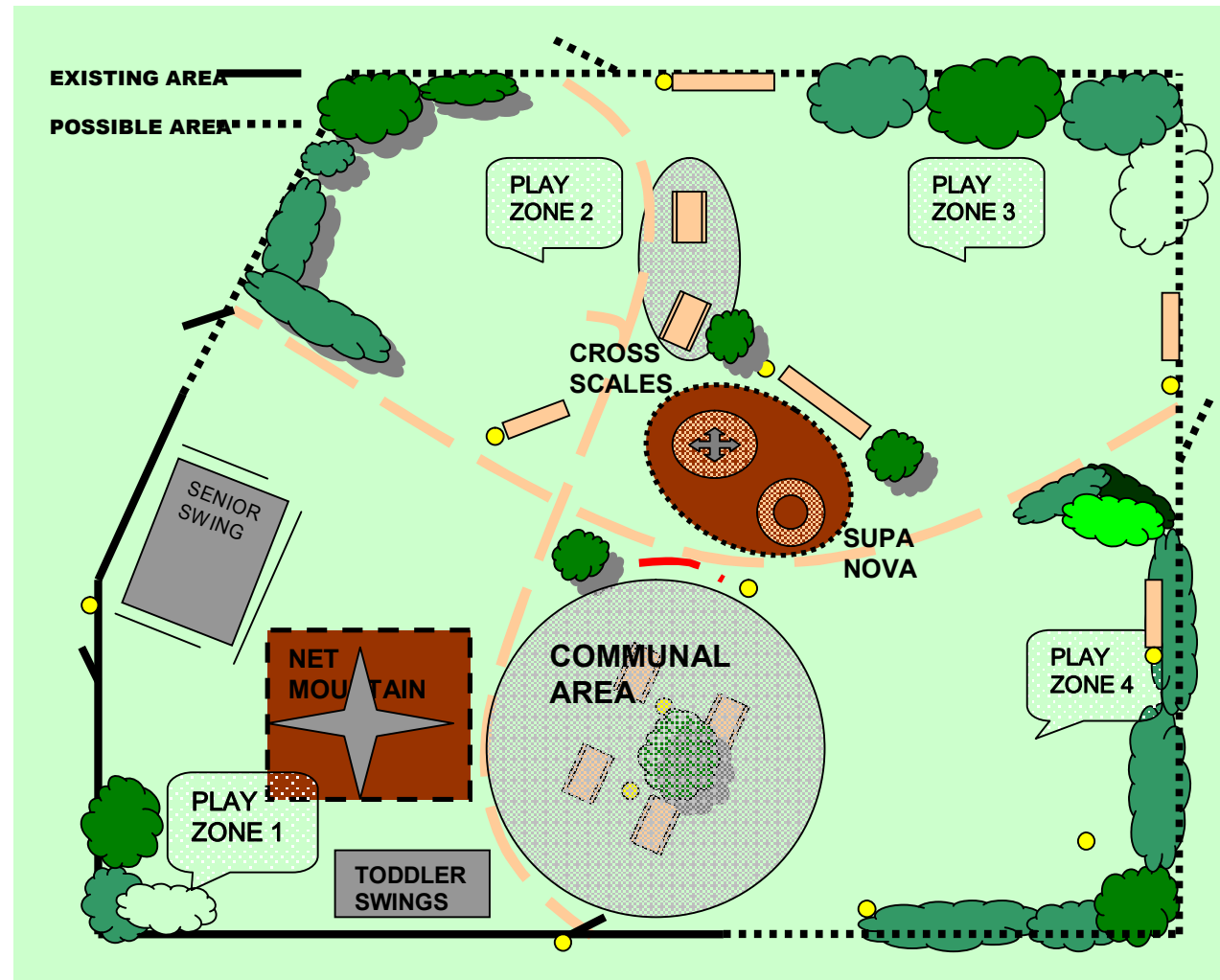

BIG LOTTERY FUNDING £28,500 Parish Council contribution £4,500 minimum Awards for All £9,800

Snoxhall Play Park Project

Summary

Big Lottery Fund	£28,500
Parish Council Contribution	£ 4,500* (project management costs)
Awards for All	£ 9,850*

£6,000 released from EMR's is available towards the next phase of the project.

To comply with the Parish Council's policy of asset management and of saving for new equipment over its life cycle, the amount needed each year to cover all of the playground equipment at this phase would be £3834 per year.

Maintenance costs would increase – larger area of grass to cut, foliage to prune and manage and additional area to check and keep safe, plus an additional annual cost for bark replacement.

To get to this stage of the project would cost £38,350 capital plus project management costs of approximately £4,500.

In addition the Parish Council would need to commit £3834 to the EMR per year and £1,300 per year towards maintenance costs from April 2009.

Snoxhall Play Park Project

MILESTONE 7

January 2010

Shelter £4,300

Big Lottery Fund

Trim trail £5,300

Parish Council
(released EMR's)

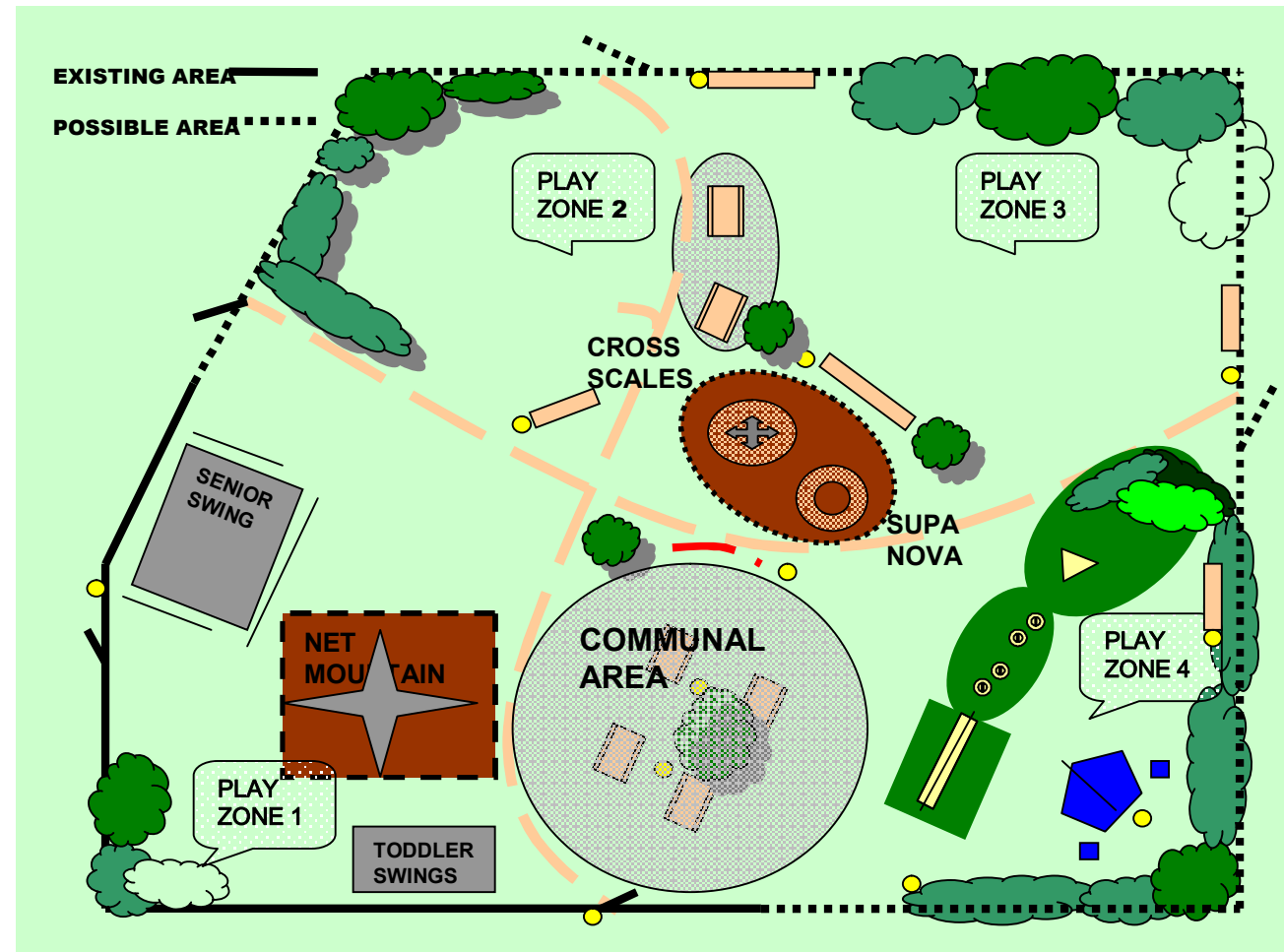

BIG LOTTERY FUNDING £32,800 Parish Council contribution £9,800 minimum,
Awards for All £9,850

Snoxhall Play Park Project

MILESTONE 8

March 2010

Suggested equipment

Nest swing £3,750

(Awards for All)

Rock and cross £5,800

(Awards for All)

Slide £5,000

(Big Lottery Funding)

Actizone £11,500

(Big Lottery Funding)

However, advice is being sought to achieve the optimum value for money.

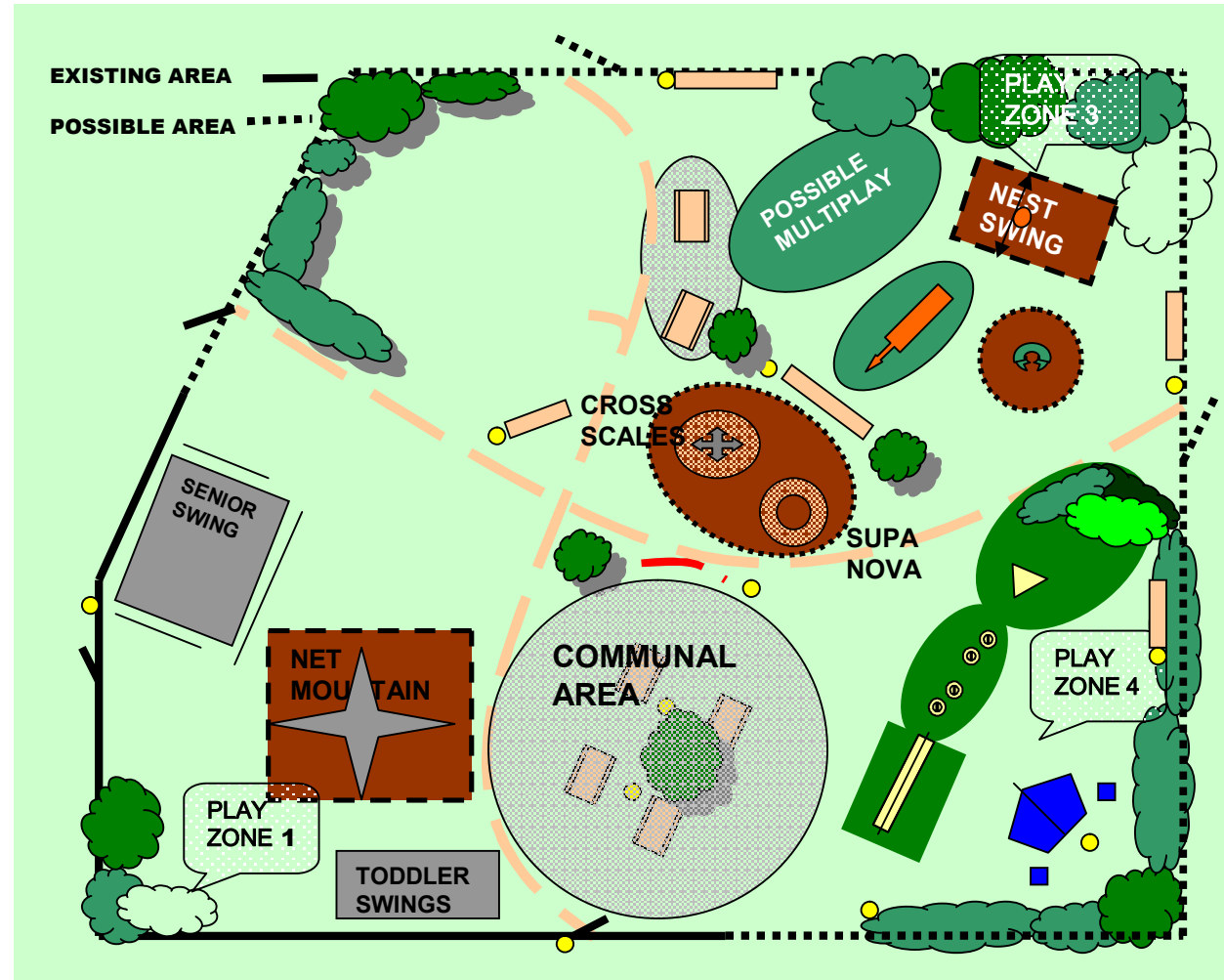

BIG LOTTERY FUNDING £49,300 Parish Council contribution £9,800 minimum, Awards for All £19,400 (two bids 2009 and 2010)

Snoxhall Play Park Project

MILESTONE 9

March 2011

Toddler zone

Fencing £2,500

Safety surfacing
£4,000

Multiplay/rockers
£1,000

Total £16,500

Funding ? – probably
from the Parish
Council. (£5,500 over
three years)

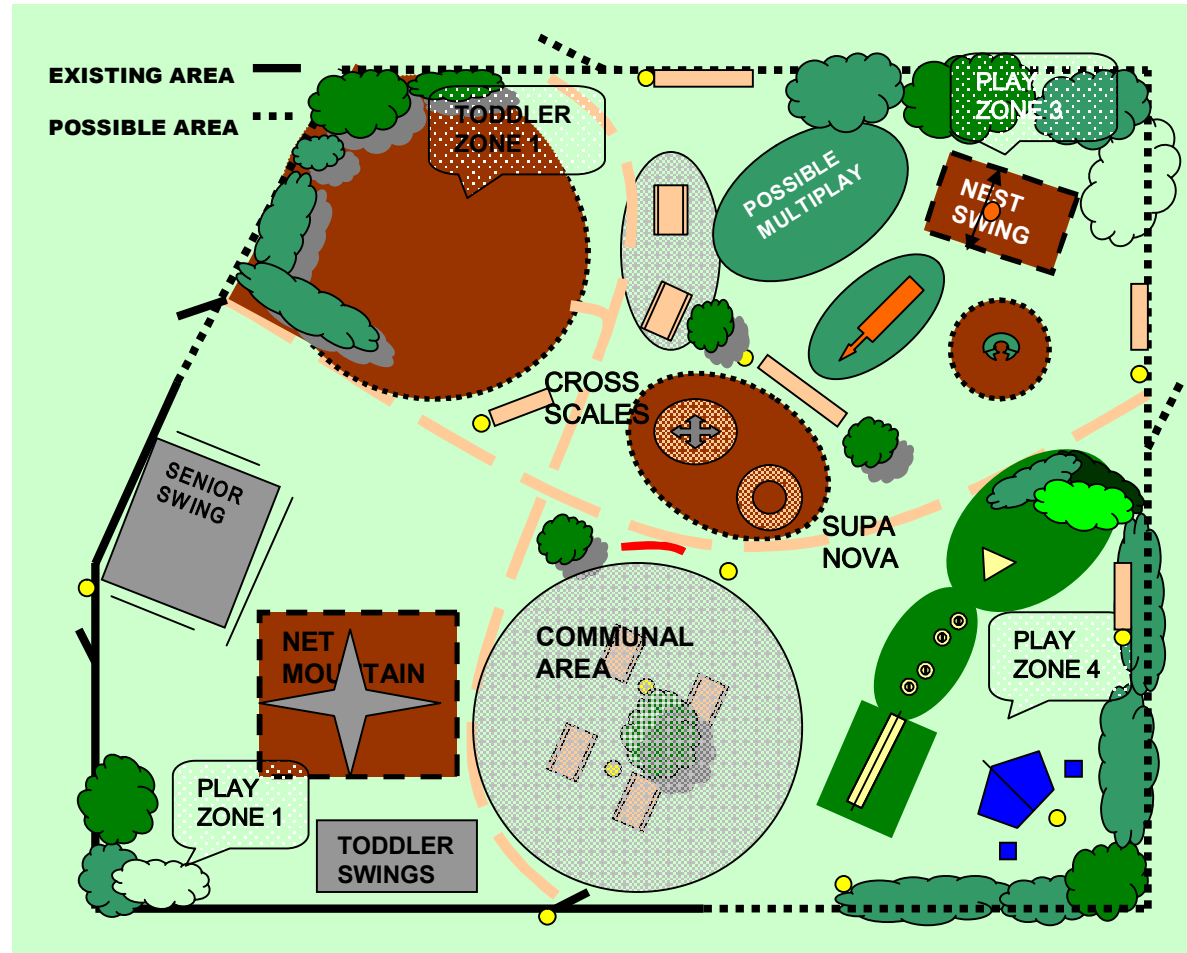

BIG LOTTERY FUNDING £49,300 Parish Council contribution £26,300
minimum, Awards for All £19,400 (two bids 2009 and 2010)

Snoxhall Play Park Project

IN THE FUTURE?

Area by stream

Pathway £7,000

YOUTH SHELTER AREA

TRIM TRAIL CONCEPT DESIGN

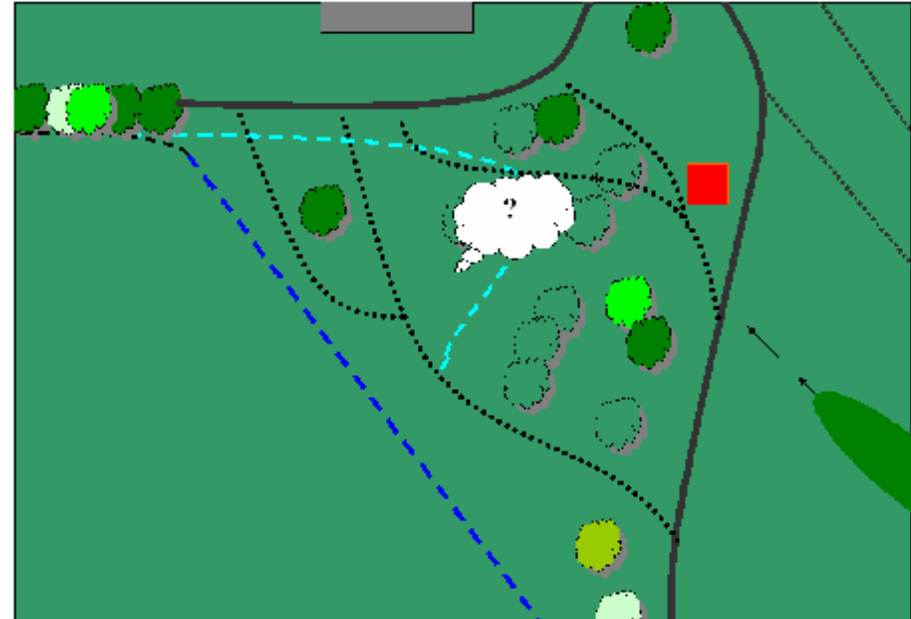
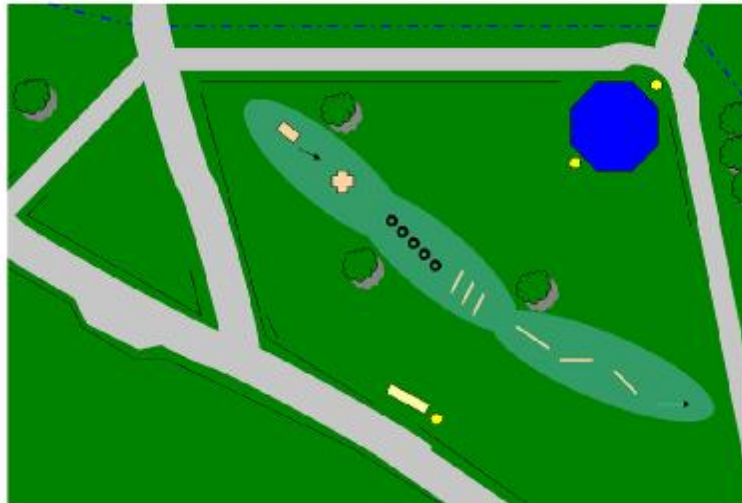

Old Youth Shelter site

Youth Shelter £15,000

Trim trail £ 7,500

Snoxhall Play Park Project

In conclusion

Whole project cost £124,500

Time frame 5 years plus

Funding

Big Lottery Fund £49,300

Awards For All £19,400

Small grant funding £,5,000

Potential cost to Parish Council £50,800 (includes 29,500 for additional areas)

additional cost to Parish Council

	2007	2008	2009	2010	2011	2012 (to include extra areas)
Rolling programme	1894	1894	3834	7399	8790	10540
Toddler area	0	5500	5500	5500	0	0
Maintenance	1300	1800	1800	1800	1800	1800